

ROY12U/16U/21U/42U DOOR

ROYAL™ METAL RACK DOOR

with Removable Mesh Insert (Black)

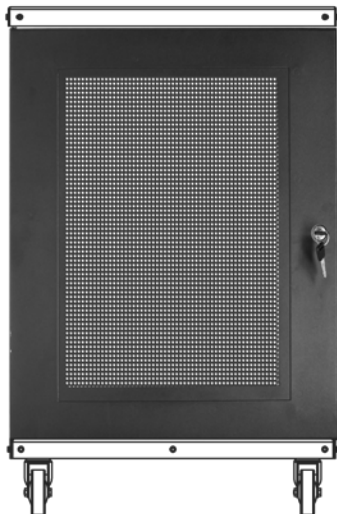

INSTALLATION MANUAL

PARTS INCLUDED

- (4) Assembly Screws, black
- (2) Keys

TOOLS NEEDED

- Phillips Head Screwdriver
- 5/16" Socket Head

INSTALLING DOOR TO FRAME

Step 1: Pull Spring Lock assembly back until pin is inside door frame (Fig. 1).

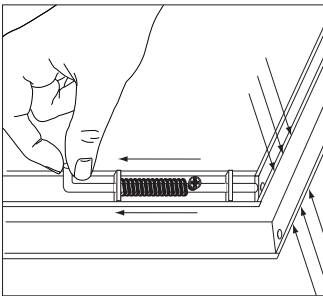

Fig. 1

Step 2: Align top left Hinge Pin and insert door into frame (Fig. 2).

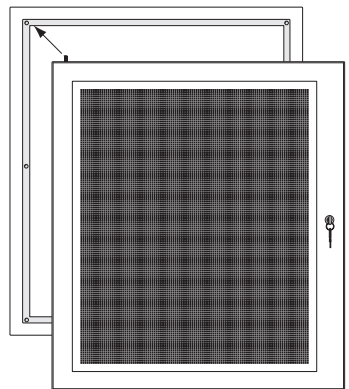

Fig. 2

Step 3: Square door within frame with tension still applied to Spring Lock assembly. (Fig. 3), With door squared in frame, release Spring Lock (Fig. 4).

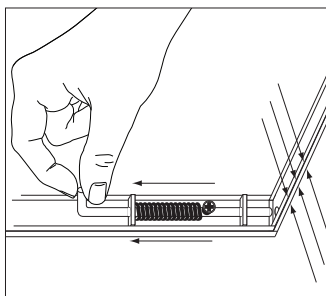

Fig. 3

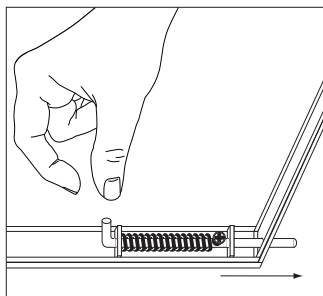

Fig. 4

NOTE: You may install Frame to Rack prior to attaching Door if necessary.

INSTALLING DOOR/FRAME TO RACK



Step 4: With fully assembled rack, loosen top two front screws halfway (Fig. 5), (Fig. 6).



Fig. 5



Fig. 6

Step 5: Open Door and hang Door Frame onto halfway installed screws (Fig. 7). Tighten down screws while making sure door frame is aligned (Fig. 8).



Fig. 7



Fig. 8

Step 6: At bottom of Door Frame, install Screws through holes (Fig. 9).

NOTE: Due to weight of the door and door frame, the frame will sway away from the door when open at this time. Support door to keep frame stable when inserting bottom screws.

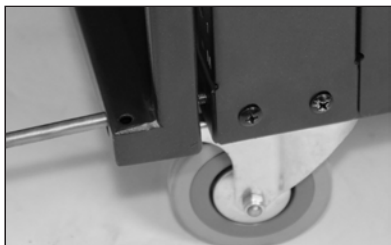

Fig. 9

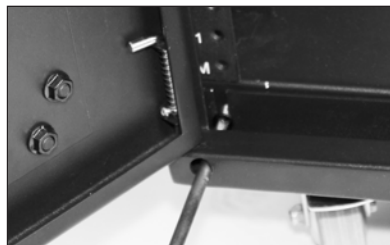

Fig. 10

Step 7: Tighten bottom screws while squaring bottom of Door Frame. (Fig. 10).

NOTE: Door may appear un-level if rack is empty. Fill with accessories to stiffen the rack.

INSERT REPLACEMENT

If you want a smoked glass/acrylic look, the mesh insert in the door is removable and can be used as a guide for a replacement insert. Due to the tight specifications of manufacturing metal, it is recommended to reduce the total height and width of the replacement by 1/16" and increase the diameter of the drilled holes by 1/16" to reduce the chance of breaking.

To remove the insert, use a 5/16" socket head and remove each hex-nut holding insert in place (Fig.11).

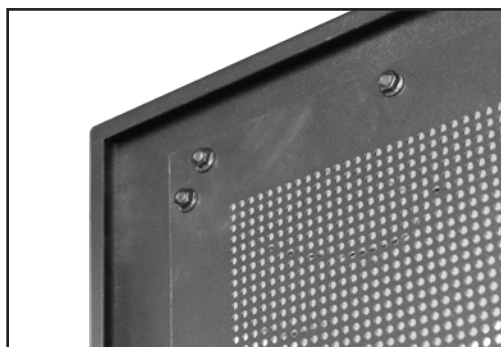

Fig. 11



Lifetime Limited Warranty

All Royal™ products have a Lifetime Limited Warranty. This warranty includes parts and labor repairs on all components found to be defective in material or workmanship under normal conditions of use. This warranty shall not apply to products which have been abused, modified, or disassembled. Products to be repaired under this warranty must be returned to Skywalker Communications or a designated service center with prior notification and an assigned return authorization number (RA).

For Technical Support: 1 (800) 844-9555